

1.5

INSOMNIAC™ 770 Contractor's Guide



Contact Us



2501 West Dunlap Avenue
Suite 255
Phoenix, Arizona 85021

Phone, Fax & Email

Technical Support	(602) 773-1700 support@opentechalliance.com
Fax	(602) 324-8658
Office	(602) 749-9370

Hours of Operation

Business Office	Monday thru Friday – 8:00am to 5:00pm MST
Technical Support	Monday thru Friday – 7:00am to 5:00pm MST Saturday – 7:00am to 2:00pm MST

INSOMNIAC™ is a registered trademark of OpenTech Alliance, Inc. “Windows” and “Internet Explorer” are registered trademarks of the Microsoft Corporation. SiteLink, SiteLink-Web, STORE, TaskMaster, Storage Manager, Domico 2000, Storage Commander, Winsen, U-Haul, StorMan, Symbio and Total Recall are registered trademarks of their respected companies, granted use with permission.

All configuration and/or installation references are appropriate practices within the U.S. Configuration and installation procedures vary by country and may result in the presence of components that differ in form and/or function from those shown in this document. Unless otherwise noted, all images, illustrations, content and all materials shown in this document are copyrights, trademarks and or intellectual properties, owned, controlled or licensed by OpenTech Alliance, Inc. This document may not be copied in whole or in part without the written consent of OpenTech Alliance, Inc. Copyright © 2012, OpenTech Alliance, Inc. all rights reserved.

DCN: 151-090429-E-EU

This page intentionally left blank

Table of Contents

Preface	7	Heat Gain/Loss Consideration.....	9
General Installation.....	7	Protection from Weather.....	9
Concrete Pad Requirements	7	INSOMNIAC 770 Specifications	10
ADA Compliance	8	Weights and Measurements.....	10
Accessibility Considerations.....	8	Product & Installation Drawings.....	11
Installation Specifications.....	8	Pedestal Base Layout	11
Power Requirements	8	Concrete Pad Specifications	12
Wired Power Specifications	8	Wiring Specifications	12
Backup Power Supply.....	8	Corner Mount Considerations	
Data Cable Requirements	9	(Without Canopy)	13
DVR Camera Connection	9	Corner Mount Considerations for	
Plenum Ceiling Consideration	9	(With Canopy)	14
Fire Protection Consideration	9		

This page intentionally left blank

Installation

Preface

Prior to installing the INSOMNIAC 770, your contractor should review the standards and information contained throughout this document. Please contact OpenTech Alliance Customer Support (via telephone at: 602-749-9370, Option 2, or email at: support@opentechalliance.com) for any upgrades or additional details or questions.

General Installation

- Check with OpenTech Alliance prior to installation for any updates to this installation guide.
- Check all applicable ADA and local codes for accessibility compliance prior to installation.
- The kiosk should be visible once a tenant enters the property from the street.
- The kiosk area should be well lit (to make the user feel safe and comfortable).
- The kiosk should be located on the exterior of the building and visible from the parking area.
- If the property utilizes video recording or surveillance, a camera should be in place to view the kiosk.
- The kiosk should offer the user protection from the elements during use; for example, shade from the hot sun and direct sunlight, and protection from rain and wind, etc.)
- Ideal installation of the kiosk will insure that it is placed just adjacent to the main office entry.
- The kiosk should be located as close to the entry keypad as possible.

Concrete Pad Requirements

The INSOMNIAC 770 must be mounted on a concrete pad. Four (4) bolts will need to be anchored into the pad with which the pedestal base is to be attached. Holes in the pedestal base allow for 3/8" bolts to be used (please follow the bolt manufacturer's recommendations when anchoring bolts in concrete). Please see Figure 1: Pedestal Base Layout (page 11) for pedestal base layout, and *Figure 2: Concrete Pad Specifications* (page 12) for concrete pad specifications.

ADA Compliance

Accessibility Considerations

The primary issue addressed by The Americans with Disabilities Act (and corresponding local accessibility code requirements), as applied to the kiosk, is provision for proper access to and from the INSOMNIAC 770 kiosk. This includes insuring the presence of an accessible route from public areas (including streets, sidewalks and parking lots).

Installation Specifications

The kiosk is designed so that the highest component (the credit card reader) is below 54" AFF (above finished floor); this will insure that the kiosk is installed at a height that is accessible to an individual in a wheelchair (for both forward and side approaches).

Power Requirements

Wired Power Specifications

The INSOMNIAC kiosk requires 110-120 VAC, 15 Amp, single-phase, three-wire un-switched power receptacles. Wiring to the receptacle must include a third-wire earth-ground (conduit ground is not acceptable.) Conduit can be run internally through the hole in the bottom of the pedestal or externally to conduit connections on the sides of the pedestal. See for electrical connection information.

Backup Power Supply

An uninterruptible power supply (UPS), also known as an uninterruptible power source, or a battery backup, is a device which maintains a continuous supply of electric power to connected equipment by supplying power from a separate source when utility power is not available. In areas of the country that experience frequent power disruptions ("Tornado Alley," hurricane season, etc.), it is recommended that a UPS be employed in order to minimize the effects of power outages.

When a power failure occurs, the UPS effectively switches from utility power to its own power source almost instantaneously. The UPS, which is continuously connected to the protected load, draws energy from its reserves, usually stored in lead-acid batteries, converting it to AC power.

In addition to providing protection against complete failure of the utility supply, a UPS also provides protection against all common power problems, and for this reason it is also known as a power or line "conditioner."

Please consult with your electrical contractor for a unit appropriate to your facility.

Data Cable Requirements

Always-On Internet Connectivity

The INSOMNIAC 770 must be connected to the computer (or network) upon which the facility's management software runs. If the facility has an "always-on" Internet connection (such as cable or DSL), the network should be configured in order to allow OpenTech Alliance, Inc's. Technical Support Specialists access to the kiosk computer, through the Internet connection.

A contractor should run a CAT 5 data cable, in grounded conduit, from the location of the computer (or network hub) that runs the management software, to a junction outlet box mounted in the pedestal of the kiosk. See *Figure 3: Wiring Specifications* on page 12 for data connection information.

DVR Camera Connection

The INSOMNIAC 770 comes pre-installed with a DVR (Digital Video Recorder) capable camera. If desired, an RG59 BNC cable may be run to the CAT5E junction box. The cable should be terminated with a female BNC connector or have a coupler available.

Plenum Ceiling Consideration

Special considerations must be made if the kiosk will utilize wiring installed through a plenum ceiling. If the area between the ceiling and the roof in a building is used for air return in a ventilation system, fire and building codes normally require that special wire or conduit be used if wire is run through this area.

Fire Protection Consideration

Installation of this kiosk in an existing facility with a new wall enclosure may impact the sprinkler head cover in this area, and require modification or addition of additional heads.

Heat Gain/Loss Consideration

Installation of this kiosk in small areas with a lack of air circulation should take into consideration the heat gain (build up of heat from operation of the equipment) and design the space accordingly.

Protection from Weather

Although the INSOMNIAC kiosk is designed for outdoor use, it should be protected from full weather exposure. A canopy, awning or other covering should be installed above the kiosk to prevent direct rain and/or snow contact. An optional canopy is available from OpenTech Alliance.

Specifications

INSOMNIAC 770 Specifications

Weights and Measurements

Shipping Weight	Unit Weight	Kiosk Dimensions	Rear Clearance
180 lbs	+/- 20 lbs	Height: 63" Width: 24" Depth: 23"	INSOMNIAC 770 opens to the front, therefore, no rear access clearance is required and the kiosk may be installed flush to a wall.
Actual shipping and unit weight depends upon shipping materials, options and configuration.		With Canopy Height: 79" Width: 24" Depth: 39"	

Drawings

Product & Installation Drawings

Pedestal Base Layout

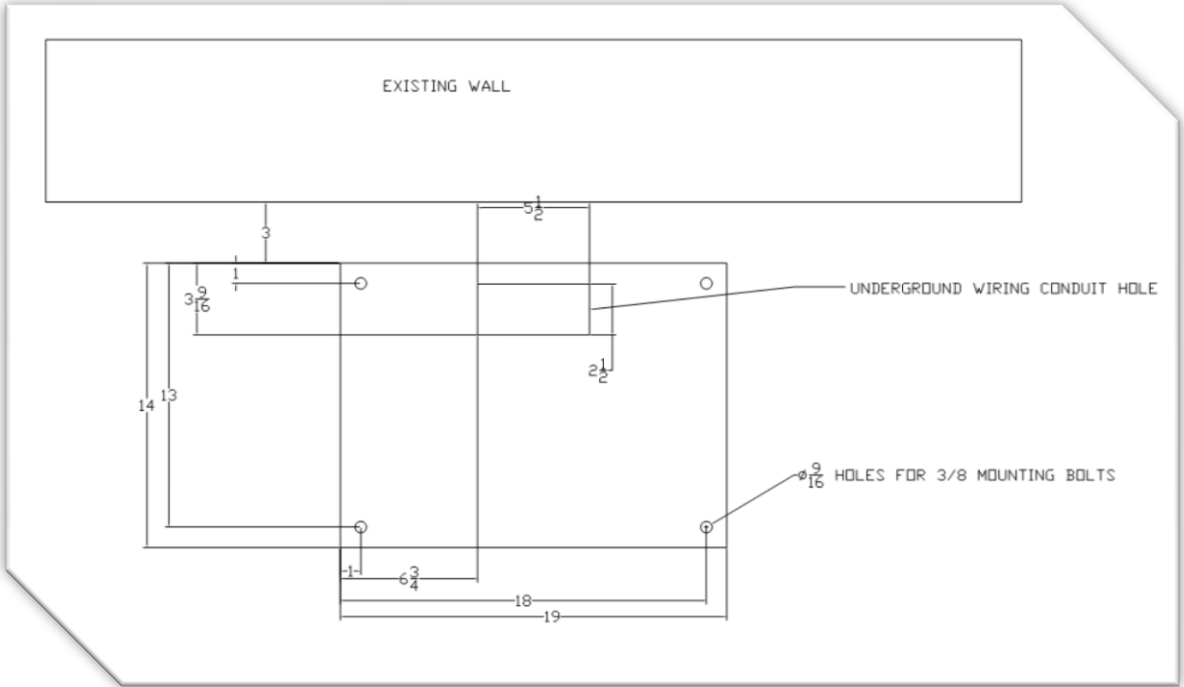

Figure 1: Pedestal Base Layout

Concrete Pad Specifications

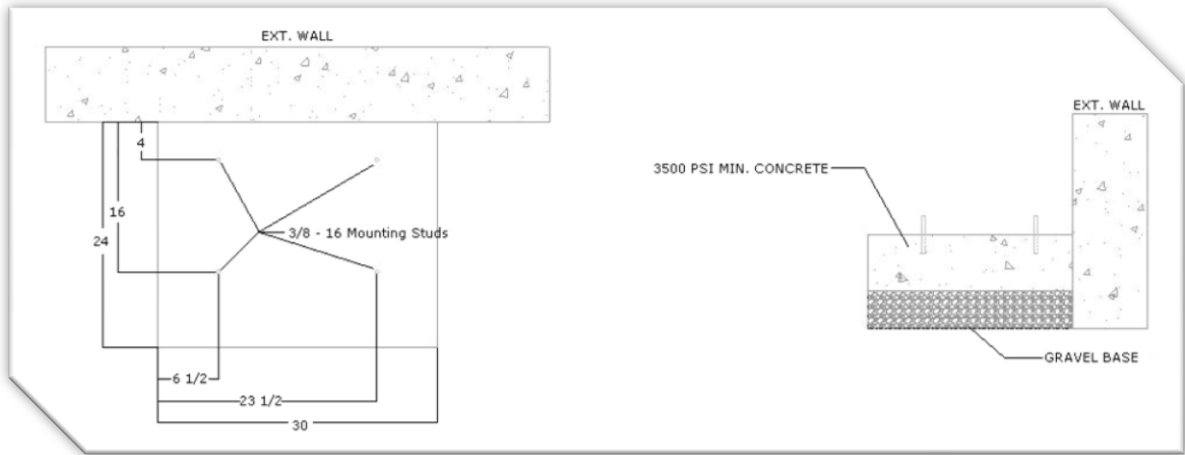

Figure 2: Concrete Pad Specifications

Wiring Specifications

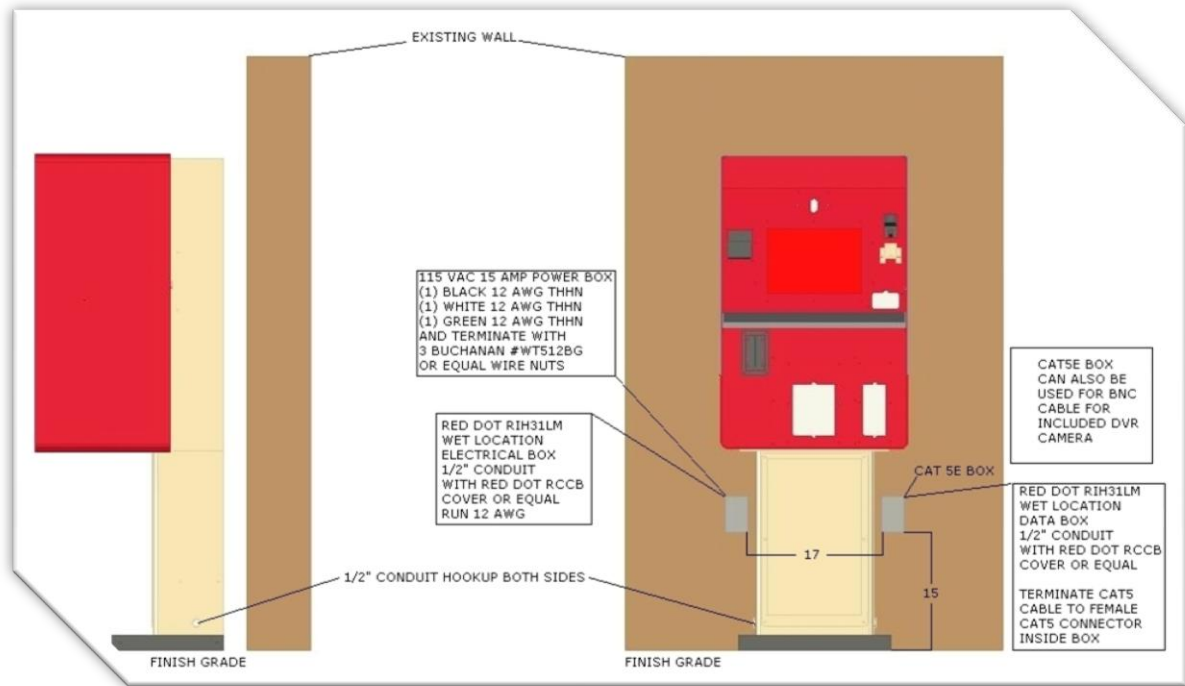

Figure 3: Wiring Specifications

Corner Mount Considerations (Without Canopy)

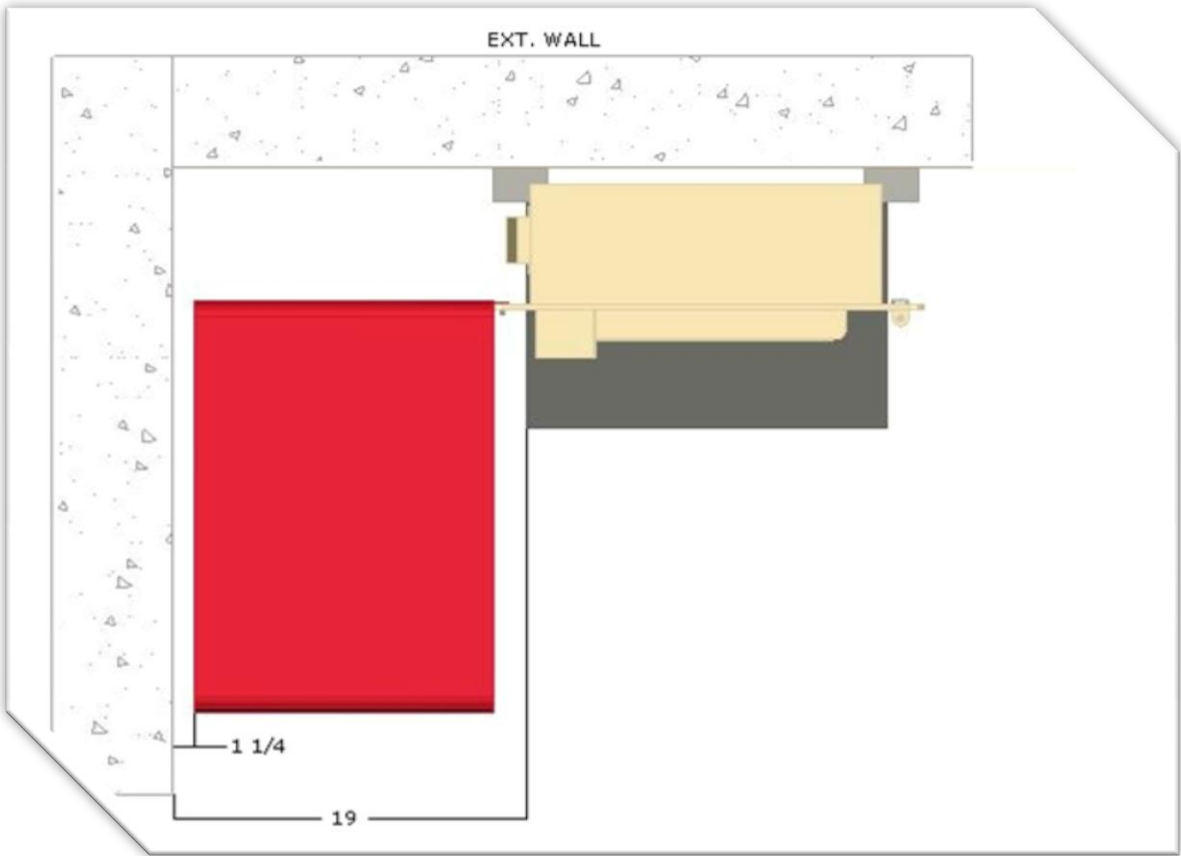

Figure 4: Corner Mount Considerations (Without Canopy)

Corner Mount Considerations for (With Canopy)

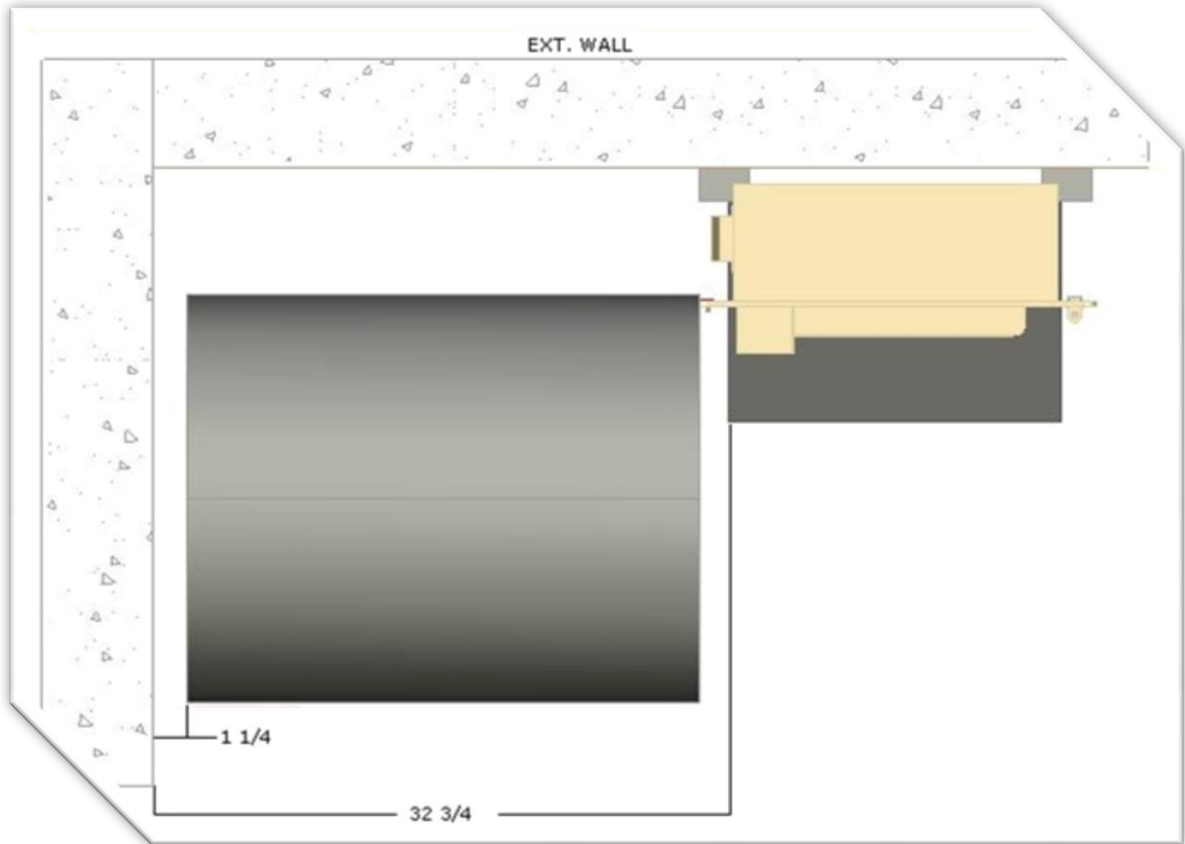

Figure 5: Corner Mount Considerations (With Canopy)

Table of Figures

Figure 1: Pedestal Base Layout	11
Figure 2: Concrete Pad Specifications	12
Figure 3: Wiring Specifications.....	12
Figure 4: Corner Mount Considerations (Without Canopy)	13
Figure 5: Corner Mount Considerations (With Canopy).....	14